

WordPerfect

# FONT DEFAULT FOR ALL DOCUMENTS



© Darryl D Eggleston, 813.677.2871, [DarrylD@darryd.com](mailto:DarrylD@darryd.com)<sup>1</sup>  
Click on the blue, underlined text to go to its linked reference.

Setting the default font for all documents created subsequent to the setting is simple. (“Default” means the properties of the document unless you change it. Here’s how to do it.

1. From the MenuBar, select Format ► Font (**Figure 1**).

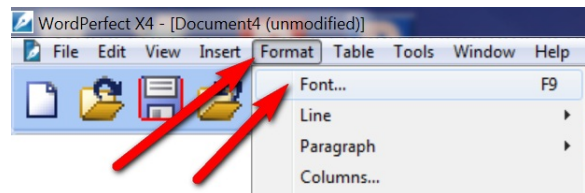

Figure 1

2. Select the font (**Figure 2**):

- ❶ Select the font.
- ❷ Select the size.
- ❸ Click on “Settings” button.
- ❹ Click on “Set face and point size as default for all documents.
- ❺ Click on “OK” button, or touch the Enter key on the keyboard.

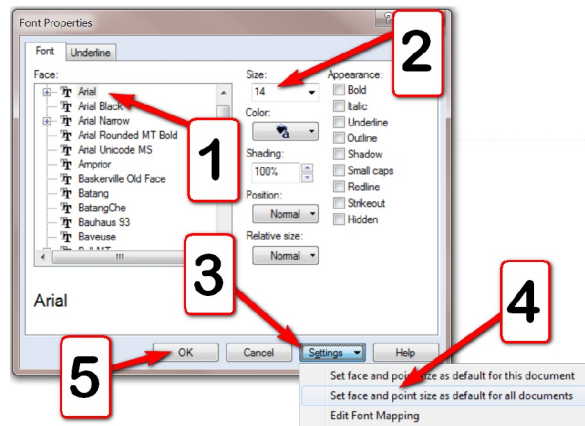

Figure 2

<sup>1</sup> Permission for reproduction in whole or in part is granted to groups and organizations for internal, non-profit use provided credit is given to the author along with the copyright notice: Article reprinted with permission. Copyright © 2010 Darryl D Eggleston, <http://DarrylD.com>. Editors: PegEgg Eggleston & Parker Monroe.